

U verw/ Your ref: Grewe SS

Ons verwysing/ Reference: Grewe SS

Navrae/ Enquiries: H.T. Schreuder

hschreuder@bvm.gov.za  
Tel. 023 – 348 2980

## ONDERBREKING VAN ELEKTRIESE TOEVOER

**Breedevale  
Munisipaliteit**

**U Masipala  
wase**

**Breedevale  
Municipality**

Geagte Verbruiker by: **Russel-; Somerset-; Trappe-; Alice-& Durban Straat (NB...Slegs waar kennis gegee is)**

Hiermee word u in kennis gestel dat die elektrisiteitstoevoer onderbreek sal word op **Dinsdag, 22/05/2018 vanaf 08h00 tot 15h00** ten einde dringende instandhoudingswerk uit te voer aan die elektrisiteitsverspreidingsnetwerk.

Geen versekering kan gegee word dat die elektrisiteitstoevoer vir die volle tydsduur af sal wees nie, u moet dit dus gedurende die genoemde tye as **LEWENDIG** beskou.

**NB: Geen verbruiker mag enige kragopwekkers op die netwerk koppel, indien daar nie aan die Regulasie vir die gebruik van kragopwekkers voldoen word nie (Regulasie SANS 8528/12). Indien 'n verbruiker wel 'n kragopwekker gebruik moet hy die kontakpersoon telefonies daarvan in kennis stel.**

Tel: +27 23 348 2600

Faks / fax +27 23 3473671

E-pos / E-mail:

Kontakpersoon: - **Mnr. H. Schreuder** Tel. Nr. **(023) 348 2980**

Webadres / Web Address

[www.bvm.gov.za](http://www.bvm.gov.za)

Die Burgersentrum  
Hoogstraat  
Privaatsak X3046  
Worcester, 6849  
Suid-Afrika

Civic Centre  
High Street  
Private Bag X3046  
Worcester, 6849  
South Africa

## NOTICE FOR THE INTERRUPTION OF ELECTRICAL SUPPLY

Dear Consumer: **Russel-; Somerset-; Trappe-; Alice-& Durban Street (PS... Only where notices were given)**

You are hereby notified that the electricity supply will be interrupted on **Tuesday, 22/05/2018 from 08h00 till 15h00** in order to do urgent maintenance work on the electricity distribution network.

No assurance can be given that the electricity supply will be **off** for the entire period and you should therefore treat it as **LIVE** during this timeslot.

**PS.: No generators may be connected by consumers to the electricity network, unless the Regulations for the use of generators are not met (SANS Regulation 8528/12). If a consumer is using a generator, he/she must notify the contact person telephonically.**

Contact Person: - **Mr. H. Schreuder** Tel. No.: **(023) 348 2980**

**H. BENECKE**  
Senior Manager Electrical Services

Rig asb. alle korrespondensie  
aan die Munisipale Bestuurder

Please address all  
correspondence to the  
Municipal Manager

SOMERSE STRAAT

HOOG STRAAT

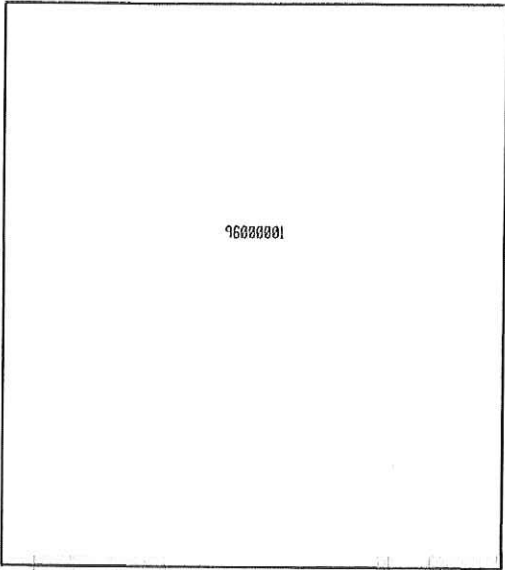

RUSSELL STRAAT

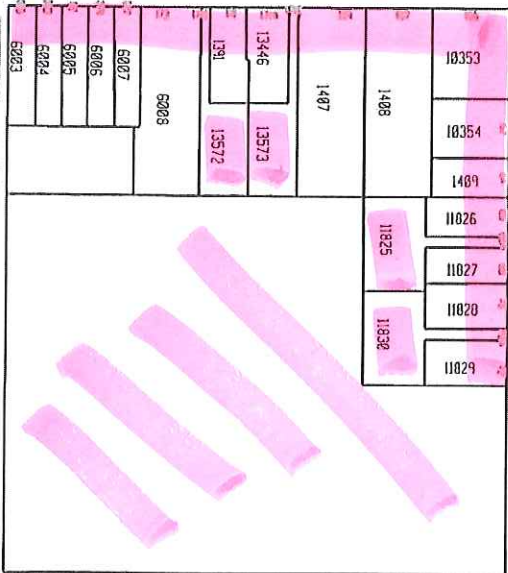

SOMERSE STRAAT

10 11 12 13 14 15

TRAPPESTRAAT

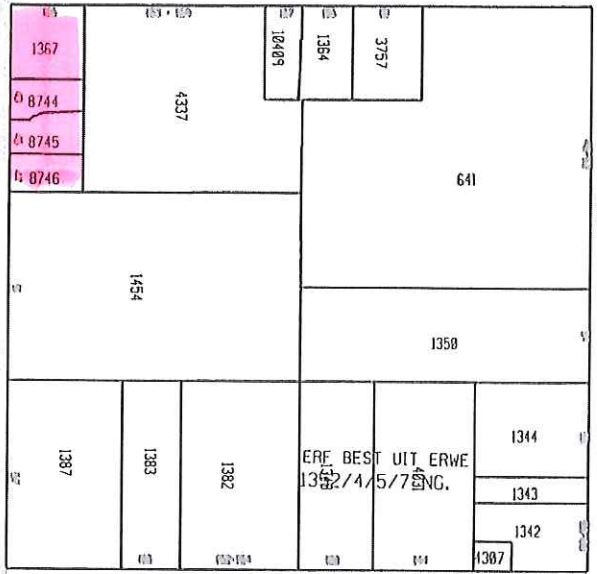

NAPIER STRAAT

NAPIER STRAAT

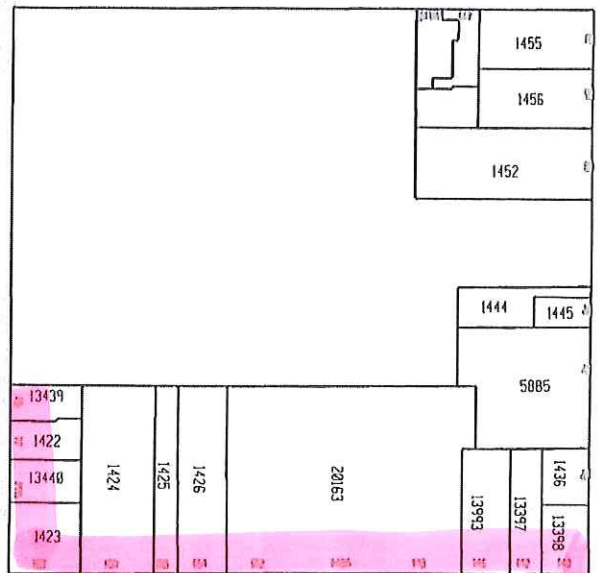

DURBAN STRAAT

35 mm Bare Conductor

4552

35 mm Bare Conductor

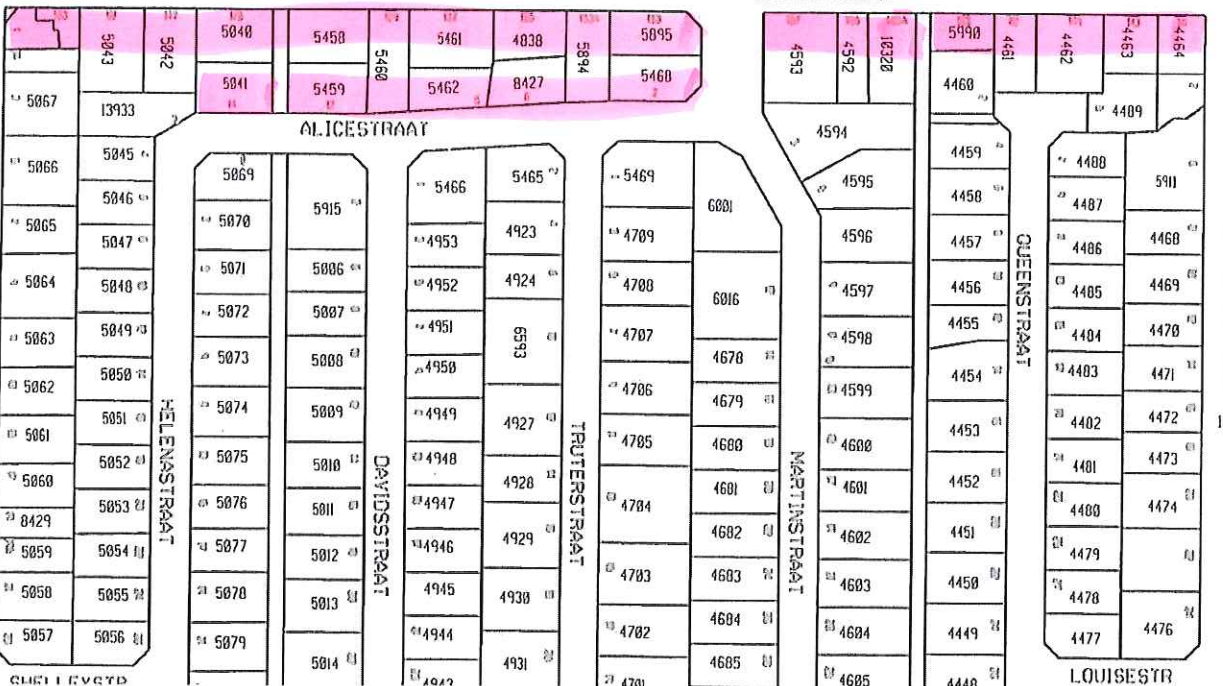

LE SUEUR STRAAT

LOUISE STR